

# Ninebot eKickScooter

- EN Product Manual
- FR Manuel du produit
- DE Produkthandbuch
- IT Manuale del prodotto
- ES Manual del producto
- PL Instrukcja obsługi
- NL Producthandleiding
- PT Manual do produto



# 1 Diagram

C2

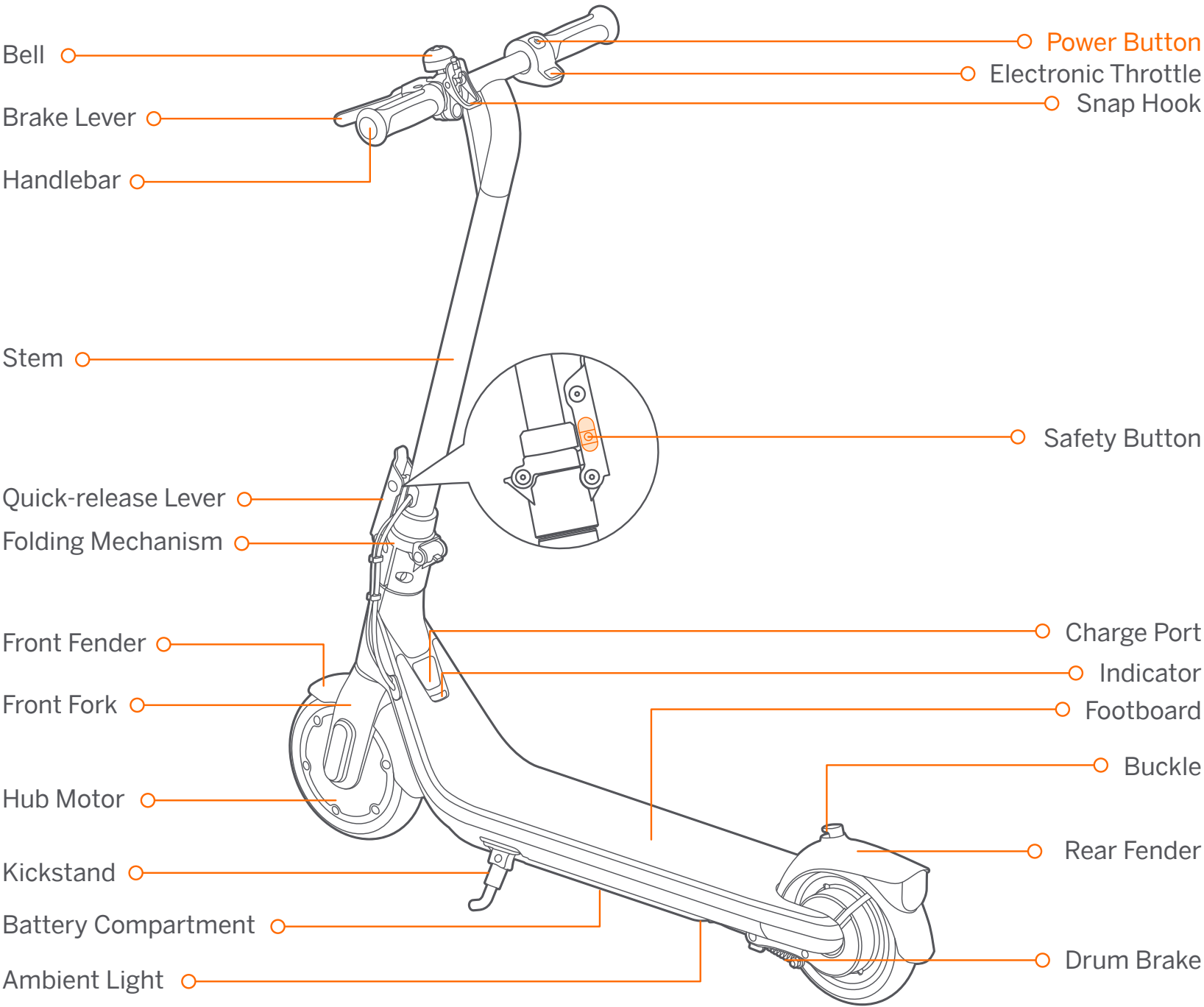

C2 Pro

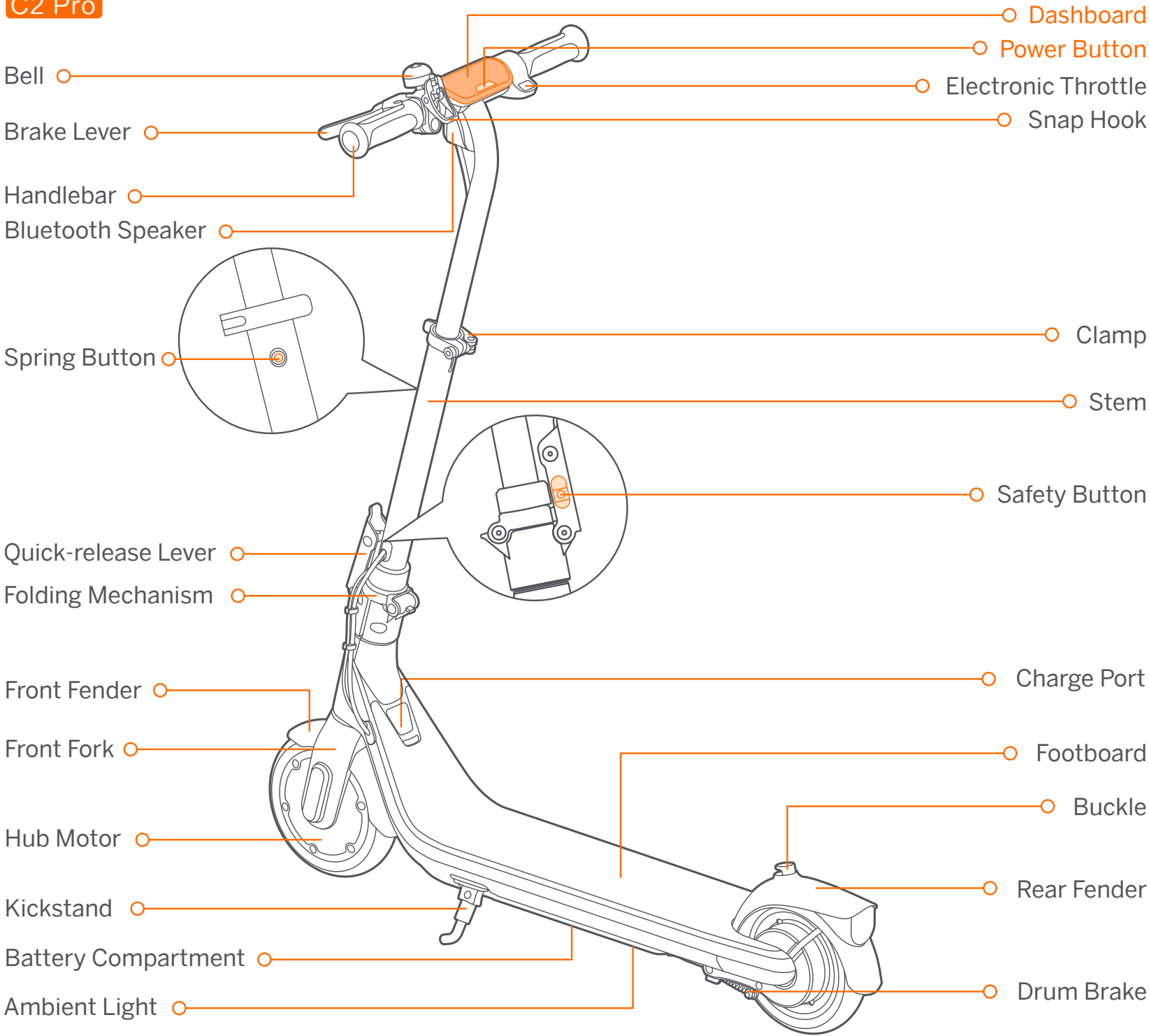

C2 Pro

Dashboard & Power Button

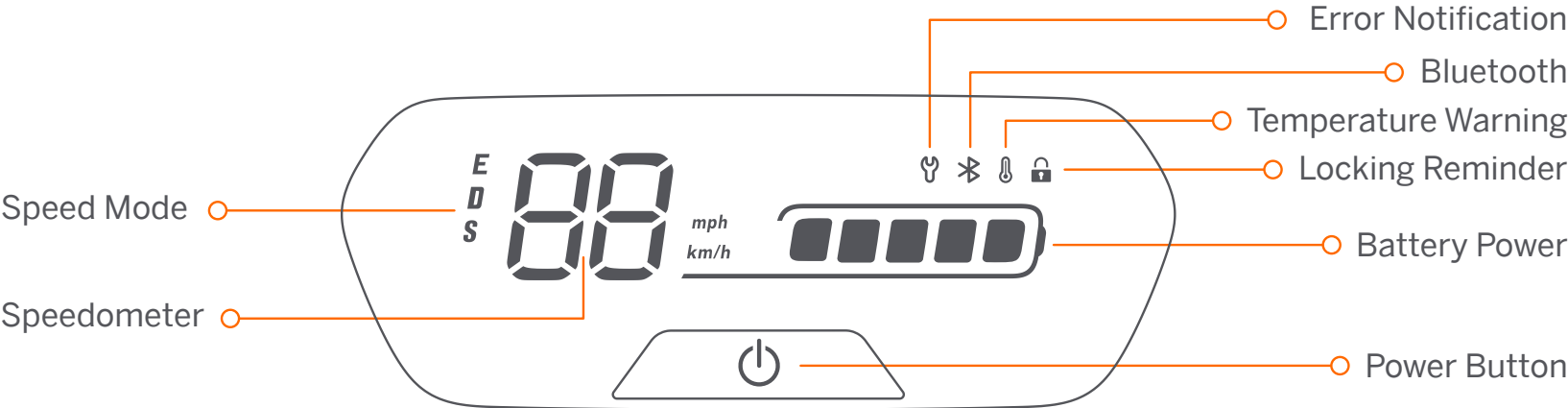

**Power Button:** Press the button to power on the scooter; press and hold the button for 2 seconds to power it off. When the scooter is on, press twice to switch between the speed modes. Press three times to turn on/off the ambient light.

**Speedometer:** It displays the current speed of the scooter, as well as error codes.

**Speed Mode:** There are three modes available. The top speed is as follows:

Mode	C2 / C2 Pro (Speed limit)	Indicator (For C2 only)
D (Standard mode)	12 km/h (7.5 mph)	flashes slowly
S (Sport mode)	16 km/h (9.9 mph)	flashes fast
E (Power-assisting mode)	16 km/h (9.9 mph)	always on

**Error Notification:** It indicates that the scooter has detected an error.

**Bluetooth:** It indicates that the scooter has been successfully connected to the mobile device.

**Temperature Warning:** It indicates that the battery temperature has reached 55°C (131°F) or is below 0°C (32°F).

\* At this point, the vehicle cannot accelerate normally and may not be charged. Do not use until the temperature has reverted to the normal range.

**Locking Reminder:** When the icon lights up, it means the scooter is locked. If abnormal movements are detected, the scooter will start beeping and the tail light will flash.

**Battery power:** The total battery power equals 5 bars.

\* The battery power is very low when the first battery bar is red. Please charge your scooter immediately.

## 2 Specifications

	Item	Parameter	
Product	Name	Ninebot eKickScooter C2	Ninebot eKickScooter C2 Pro
	Model	051403E	051404E
	Length × Width × Height	Approx. 910 × 400× 960 mm (35.8 × 15.7 × 37.8 in)	Approx. 910 × 400× (885/960/1035) mm (35.8 × 15.7 × 34.8/37.8/40.7 in)
	Folded: Length × Width × Height	Approx. 910 × 400× 500 mm (35.8 × 15.7 × 19.7 in)	
	Net Weight	Approx. 10.4 kg (22.9 lbs)	Approx. 10.7 kg (23.6 lbs)
Rider	Max. Payload	50 kg (110 lbs)	
	Recommended Age	6+	
	Required Height	120–165 cm (3'9"–5'4")	
Machine	Max. Speed	Approx. 16 km/h (9.9 mph)	
	Theoretical Range <sup>[1]</sup>	Approx. 11 km (6.8 miles)	Approx. 17 km (10.6 miles)
	Riding Time <sup>[2]</sup>	Approx. 56 mins	Approx. 1.5 h
	Max. Slope	Approx. 5%	
	Traversable Terrain	Mostly smooth roads or normal asphalt, tarmac roads	
	Operating Temperature	-10–40°C (14–104°F)	
	Storage Temperature	-10–50°C (14–122°F)	
	IP Rating	IPX4	
	Duration of Charging	Approx. 3.5 h	Approx. 4 h
Battery	Nominal Voltage	21.6 V $\text{---}$	
	Max. Charging Voltage	25.2 V $\text{---}$	
	Charging Temperature	0°C–45°C (32–113°F)	
	Nominal Capacity	54 Wh	108 Wh
	Nominal Energy	2500 mAh	5000 mAh
	Battery Management System	Protection against overvoltage/undervoltage/short circuit/overcurrent/overheat	
Motor	Nominal Power	130 W	150 W
	Max. power	160 W	260 W
Charger	Model	NBW25D201D0D	NBW25D201D5N-EU
	Output Power	24.2 W	36.3 W
	Input Voltage	100-240 V~ 50-60 Hz	
	Max. Output Voltage	25.2 V $\text{---}$	
	Rated Output	24.2 V $\text{---}$ 1 A	24.2 V $\text{---}$ 1.5A
Tire	Tires	7-inch inner hollow shock-absorbing tires	

[1]: Theoretical Range: tested while riding with a full battery, 110 lbs (50 kg) load, 77°F (25°C), 70% of max. speed on average on pavement.

\* Some of the factors that affect range include speed, load, number of starts and stops, ambient temperature, etc.

[2]: Riding time under the testing conditions of theoretical range.

### 3 Certifications

This product is certified to ANSI/CAN/UL-2272 by TUV Rheinland.

The battery complies with UN/DOT 38.3.

The battery complies with ANSI/CAN/UL-2271.

#### European Union Compliance Statement

##### Information on Disposal for Users of Waste Electrical & Electronic Equipment



This symbol on the product or on its packaging indicates that used electrical and electronic products should not be mixed with unsorted municipal waste. For proper treatment, it is your responsibility to dispose of your waste equipment by arranging to return it to designated collection points.

Disposing of this product correctly will help save valuable resources and prevent any potential negative effects on human health and the environment, which could otherwise arise from inappropriate waste handling.

Penalties may be applicable for incorrect disposal of this waste, in accordance with your national legislation.

Please contact your local authority for further details of your nearest designated collection point.

##### Battery recycling information for Users



This symbol means that batteries and accumulators, at their end-of-life, should not be mixed with unsorted municipal waste. Your participation is an important part of the effort to minimize the impact of batteries and accumulators on the environment and on human health. For proper recycling you can return this product or the batteries or accumulators it contains to your supplier or to a designated collection point.

Disposing of this product correctly will help save valuable resources and prevent any potential negative effects on human health and the environment, which could otherwise arise from inappropriate waste handling.

Penalties may be applicable for incorrect disposal of this waste, in accordance with your national legislation.

there are separate collection systems for used batteries and accumulators.

Please, dispose of batteries and accumulators correctly at your local community waste collection/recycling center.

### **Electromagnetic Compatibility Directive**

Ninebot (Changzhou) Tech Co., Ltd. hereby declares that the product listed in this section comply with the essential requirements and other relevant provisions of the Electromagnetic Compatibility Directive 2014/30/EU.

### **Restriction of the use of certain hazardous substances (RoHS) Directive**

Ninebot (Changzhou) Tech Co., Ltd. hereby declares the whole product including parts (cables, cords, and so on) meets the requirements of RoHS Directive 2011/65/EU and amendment Commission Delegated Directive (EU) 2015/863 on the restriction of the use of certain hazardous substances in electrical and electronic equipment ("RoHS recast" or "RoHS 2.0").

### **The Safety of Toy Directive**

Ninebot (Changzhou) Tech Co., Ltd. hereby declares that the product listed in this section comply with the essential requirements and other relevant provisions of The Safety of Toy Directive 2009/48/EC.

### **Radio Equipment Directive**

Ninebot (Changzhou) Tech Co., Ltd. hereby declares that the product listed in this section comply with the essential requirements and other relevant provisions of the Radio Equipment Directive 2014/53/EU.



EU Authorised Representative:

Segway-Ninebot Europe

Dynamostraat 7, 1014 BN Amsterdam, The Netherlands.

Ninebot (Changzhou) Tech Co., Ltd. hereby declares that the product model: 051403E, 051404E comply with the essential requirements and other relevant provisions of the Electromagnetic Compatibility 2014/30/EU, The Radio Equipment Directive 2014/53/EU, The Safety of Toy Directive 2009/48/EC and the RoHS Directive 2011/65/EU and amendment Commission Delegated Directive (EU) 2015/863.

Ninebot (Changzhou) Tech Co., Ltd. hereby declares that the product model: 051403E Comply with the essential requirements and other relevant provisions of the Electromagnetic Compatibility 2014/30/EU, The Safety of Toy

Directive 2009/48/EC and the RoHS Directive 2011/65/EU and amendment Commission Delegated Directive (EU) 2015/863.

The declaration of conformity can be viewed at the following address: <https://eu-en.segway.com/instruction-manuals>

## **UK Compliance Statement**

### **Electromagnetic Compatibility Regulations 2016**

Ninebot (Changzhou) Tech Co., Ltd. hereby declares that the product listed in this section comply with the essential requirements and other relevant provisions of Electromagnetic Compatibility Regulations 2016.

### **The Restriction of the Use of Certain Hazardous Substances in Electrical and Electronic Equipment Regulations 2012**

Ninebot (Changzhou) Tech Co., Ltd. hereby declares the whole product including parts (cables, cords, and so on) meets the requirements of The Restriction of the Use of Certain Hazardous Substances in Electrical and Electronic Equipment Regulations 2012.

### **Toys (Safety) Regulations 2011**

Ninebot (Changzhou) Tech Co., Ltd. hereby declares that the product listed in this section comply with the essential requirements and other relevant provisions of Toys (Safety) Regulations 2011.

### **Radio Equipment Regulations 2017**

Ninebot (Changzhou) Tech Co., Ltd. hereby declares that the product listed in this section comply with the essential requirements and other relevant provisions of Radio Equipment Regulations 2017.



UK Authorised Representative:

UKCA Experts Ltd.

Dept 302, 43 Owston Road Carcroft, Doncaster, DN6 8DA, United Kingdom

Ninebot (Changzhou) Tech Co., Ltd. hereby declares that the product model: 051403E, 051404E comply with the essential requirements and other relevant provisions of the Electromagnetic Compatibility Regulations 2016, Radio Equipment Regulations 2017, Toys (Safety) Regulations 2011 and the Restriction of the Use of Certain Hazardous Substances in Electrical and Electronic Equipment Regulations 2012.



Ninebot (Changzhou) Tech Co., Ltd. hereby declares that the product model: 051403E comply with the essential requirements and other relevant provisions of the Electromagnetic Compatibility Regulations 2016, Toys (Safety) Regulations 2011 and the Restriction of the Use of Certain Hazardous Substances in Electrical and Electronic Equipment Regulations 2012.

The declaration of conformity can be viewed at the following address: <https://eu-en.segway.com/instruction-manuals>