

Ninebot KickScooter

- EN Product Manual
- FR Manuel du Produit
- ES Manual del producto



ninebot®

1 Diagram

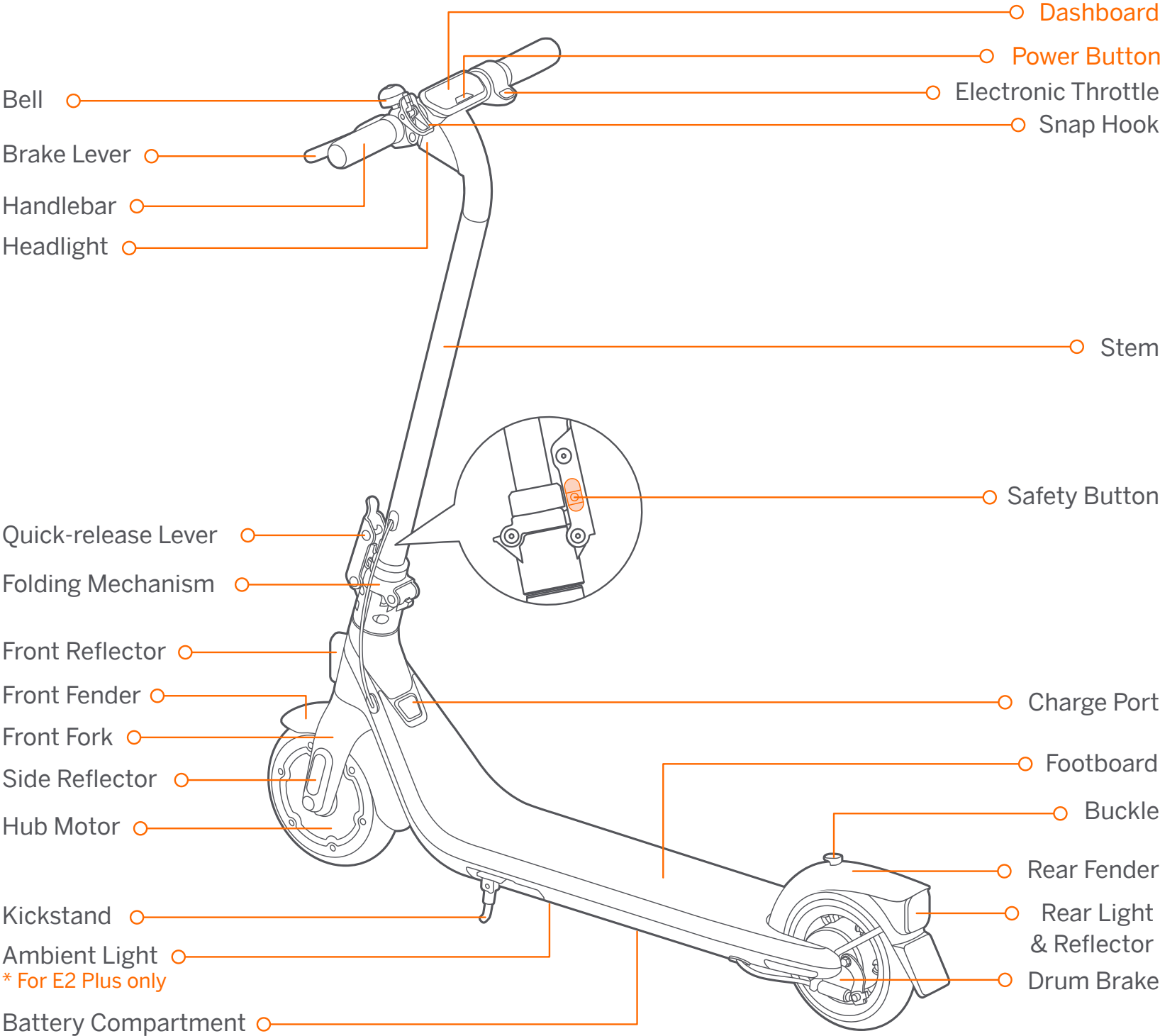

Dashboard & Power Button

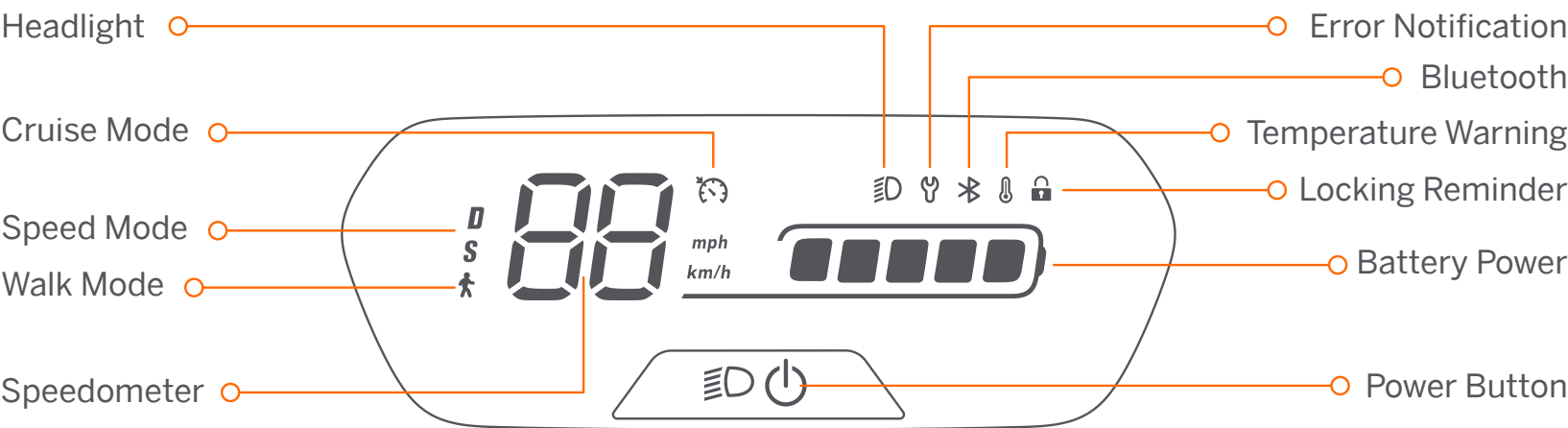

Power Button: Press the button to power on the scooter; press and hold the button for 3 seconds to power it off. When the scooter is on, press the power button to turn on/off the headlight and the rear light, and press twice to switch between the speed modes.

Speedometer: It displays the current speed of the scooter, as well as error codes.

Speed Mode: There are two modes available. The top speed is as follows:

Mode \ Model	E2	E2 Plus
D (Standard mode)	9.3 mph (15 km/h)	12.4 mph (20 km/h)
S (Sport mode)	12.4 mph (20 km/h)	15.5 mph (25 km/h)

Walk Mode: Max. speed is 5 km/h (3.1 mph). The headlight and tail light are always on and can't be turned off.

* How to enable in the Segway-Ninebot app: Settings > Walk Mode.

Error Notification: It indicates that the scooter has detected an error.

Temperature Warning: It indicates that the battery temperature has reached 55°C (131°F) or is below 0°C (32°F).

* At this point, the scooter cannot accelerate normally and may not be charged. Do not use until the temperature has reverted to the normal range.

Bluetooth: It indicates that the scooter has been successfully connected to the mobile device.

Battery power: The total battery power equals 5 bars.

* The battery power is very low when the first battery bar is red. Please charge your scooter immediately.

Locking Reminder: When the icon lights up, it means the scooter is locked. If abnormal movements are detected, the scooter will start beeping and the tail light will flash.

Cruise Mode: When the icon lights up, it means cruise mode is turned on.

2 Specifications

	Item	Parameter	
Product	Name	Ninebot KickScooter E2	Ninebot KickScooter E2 Plus
	Model	051401U	051402U
	Length × Width × Height	Approx. 45.2 × 17.5 × 42.3 in (1147 × 445 × 1075 mm)	
	Folded: Length × Width × Height	Approx. 45.2 × 17.5 × 19.7 in (1147 × 445 × 500 mm)	
	Net Weight	Approx. 30.8 lbs (14 kg)	Approx. 31.7 lbs (14.4 kg)
Rider	Max. Payload	198.4 lbs (90 kg)	
	Recommended Age	14+	
	Required Height	3'11"–6'6" (120–200 cm)	
Machine	Max. Speed	Approx. 12.4 mph (20 km/h)	Approx. 15.5 mph (25 km/h)
	Theoretical Range ^[1]	Approx. XX miles (XX km)	
	Typical Range ^[2]	Approx. XX miles (XX km)	
	Max. Slope	Approx. 10%	
	Traversable Terrain	Mostly smooth roads or normal asphalt, tarmac roads	
	Operating Temperature	14–104°F (-10–40°C)	
	Storage Temperature	14–122°F (-10–50°C)	
	IP Rating	IPX4	
	Duration of Charging	Approx. 8 h	
Battery	Model	NEEF2210A	
	Nominal Voltage	21.6 V ===	
	Max. Charging Voltage	25.2 V ===	
	Charging Temperature	32–111°F (0°C –44°C)	
	Nominal Energy	220 Wh	
	Nominal Capacity	10.2 Ah	
	Battery Management System	Protection against overvoltage/undervoltage/short circuit/overcurrent/over temperature	
Motor	Nominal Power	0.25 kW, 250 W	0.3 kW, 300 W
	Max. power	0.50 kW, 500 W	0.56 kW, 560 W
Charger	Model	NBW25D201D5N-US	
	Output Power	36.3 W	100-240
	Input Voltage	V~ 50-60 Hz	
	Max. Output Voltage	25.2 V ===	
	Rated Output	24.2 V === 1.5 A	
Tire	Tires	8.1-inch rubber hollow tire	

[1]: Theoretical Range: tested while riding with a full battery, 165 lbs (75 kg) load, 77°F (25°C), 70% of max. speed on average on pavement.

[2]: Typical Range: tested while riding with a full battery, 165 lbs (75 kg) load, 77°F (25°C), at the max. speed on average on pavement.

* Some of the factors that affect range include speed, load, number of starts and stops, ambient temperature, etc.

3 Certifications

This product is certified to ANSI/CAN/UL-2272 by TUV Rheinland.

The battery complies with UN/DOT 38.3.

The battery complies with ANSI/CAN/UL-2271.

Federal Communications Commission (FCC) Compliance Statement for USA

This device complies with part 15 of the FCC rules. Operation is subject to the following two conditions: (1) This device may not cause harmful interference, and (2) this device must accept any interference received, including interference that may cause undesired operation.

Any Changes or modifications not expressly approved by the party responsible for compliance could void the user's authority to operate the equipment.

NOTE

This equipment has been tested and found to comply with the limits for a Class B digital device, pursuant to part 15 of the FCC Rules. These limits are designed to provide reasonable protection against harmful interference in a residential installation. This equipment generates, uses and can radiate radio frequency energy and, if not installed and used in accordance with the instructions, may cause harmful interference to radio communications. However, there is no guarantee that interference will not occur in a particular installation. If this equipment does cause harmful interference to radio or television reception, which can be determined by turning the equipment off and on, the user is encouraged to try to correct the interference by one or more of the following measures:

- Reorient or relocate the receiving antenna.
- Increase the separation between the equipment and receiver.
- Connect the equipment into an outlet on a circuit different from that to which the receiver is connected.
- Consult the dealer or an experienced radio/TV technician for help.

This equipment complies with FCC radiation exposure limits set forth for an uncontrolled environment. This equipment should be installed and operated with minimum distance 5 mm between the radiator & your body. Cet équipement est conforme aux limites d'exposition aux radiations de la IC définies pour un environnement non contrôlé. Cet équipement doit être installé et utilisé à une distance minimale de 5 mm entre le radiateur et votre corps.

Industry Canada (IC) Compliance Statement for Canada

This device complies with Industry Canada license-exempt RSS standard (s). Operation is subject to the following two conditions: (1) this device may not cause interference, and (2) this device must accept any interference, including interference that may cause undesired operation of the device.

CAN ICES-3 (B)/NMB-3(B).

L'appareil contient des émetteurs/récepteurs exempts de licence qui sont conformes aux CNR exempts de licence d'Innovation, Sciences et Développement économique Canada. L'exploitation est soumise aux deux conditions suivantes :



Raccolta Carta

- EN The manufacturer reserves the right to make changes to the product, release firmware updates, and update this manual at any time. Visit www.segway.com or check the Segway-Ninebot app to download the latest user materials. You must install the app, activate your KickScooter, and obtain the latest updates and safety instructions.
- FR Le fabricant se réserve le droit d'apporter des modifications au produit, de publier des mises à jour du microprogramme et de réviser ce manuel à tout moment. Visitez www.segway.com ou consultez l'application Segway-Ninebot pour télécharger les derniers contenus utilisateur. Vous devez installer l'application, activer votre trottinette et obtenir les dernières mises à jour et consignes de sécurité.
- ES El fabricante se reserva el derecho a realizar cambios en el producto, actualizaciones del firmware y modificaciones de este manual en cualquier momento. Visita www.segway.com o revisa la app para descargar los materiales de usuario más recientes. Debes instalar la aplicación Segway-Ninebot, activar tu KickScooter y obtener las actualizaciones e instrucciones de seguridad más recientes.

- EN The pictures shown are for illustration purposes only. The actual product may vary.
- FR La photo est pour référence seulement. Veuillez vous référer au produit réel pour plus de détails.
- ES La imagen es solo de referencia. Remítase al producto en sí para ver más detalles.